

# 5+1 PLAN

(24)

5+1

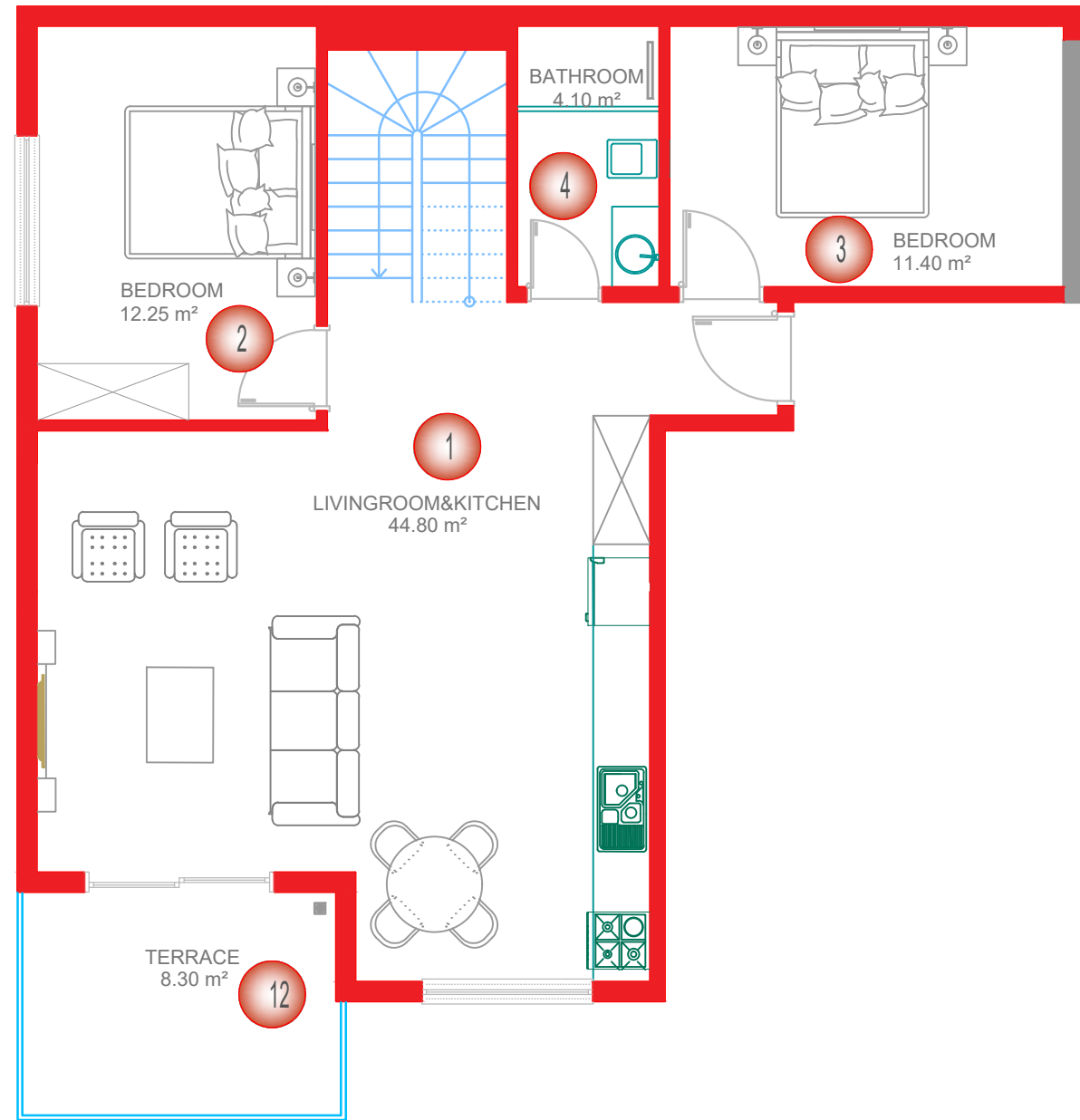
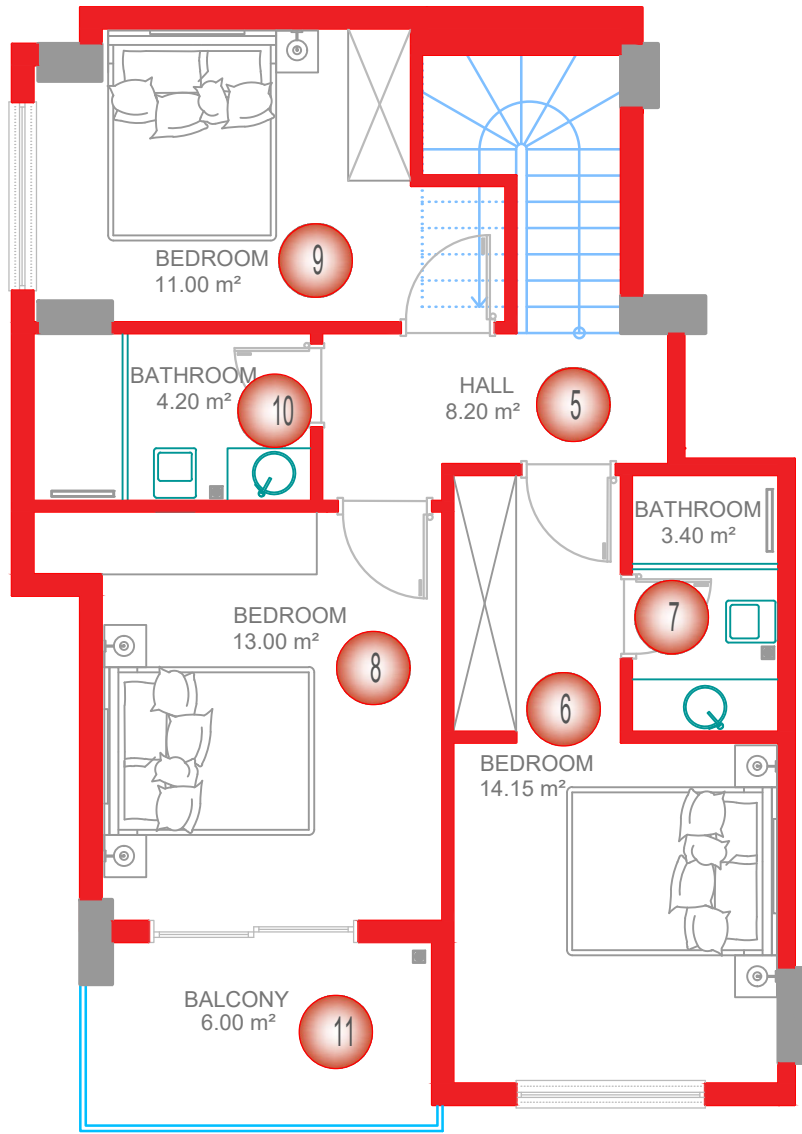

1 - LIVINGROOM&KITCHEN	: 44.80 m <sup>2</sup>
2 - BEDROOM	: 12.25 m <sup>2</sup>
3 - BEDROOM	: 11.40 m <sup>2</sup>
4 - BATHROOM	: 4.10 m <sup>2</sup>
5 - HALL	: 8.20 m <sup>2</sup>
6 - BEDROOM	: 14.15 m <sup>2</sup>
7 - BATHROOM	: 3.40 m <sup>2</sup>
8 - BEDROOM	: 13.00 m <sup>2</sup>
9 - BEDROOM	: 11.00 m <sup>2</sup>
10 - BATHROOM	: 4.20 m <sup>2</sup>
11 - BALCONY	: 6.00 m <sup>2</sup>
12 - TERRACE	: 8.30 m <sup>2</sup>
WALL	: 25.00 m <sup>2</sup>
TOTAL AREA	: 165.80 m <sup>2</sup>

